

**VEGETATION LEGEN**

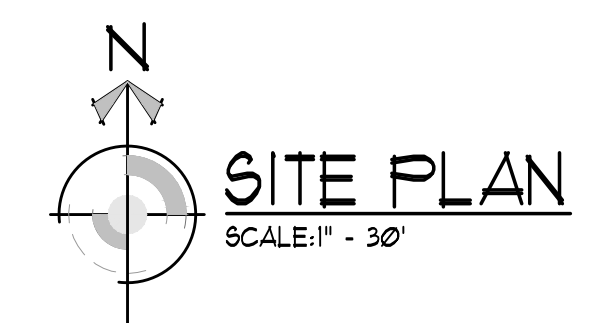

**GENERAL NOTES**

- PROPERTY ADDRESS - 1638 BROADMOOR AVE - BROADMOOR / CHERRY VALLEY CORRIDOR OVERLAY DISTRICT
- FFN - 41-23-17-100-019
- LEGAL DESCRIPTIONS  
THE NORTH 3411 FT. OF THAT PART OF THE NW 1/4 LYING EASTERLY OF THE EAST LINE OF BROADMOOR AVE LIGHT OF WAY (120 FT WIDE) SECTION 17, T8N, R10W, 4 O ZONE.
- EXISTING ZONING - RURAL RESIDENTIAL (RR) - BROADMOOR / CHERRY VALLEY CORRIDOR OVERLAY DISTRICT
- RURAL RESIDENTIAL DISTRICT REGULATIONS:  
A. MIN. LOT AREA - 2 ACRES REQ'D - 4.02 AC PROV'D  
B. WIDTH - 200 FT REQ'D - 303 FT PROV'D  
C. FRONT YARD - 50 FT REQ'D (RR) - 75 FT REQ'D (B/CV OVERLAY) - 245 FT. PROV'D  
D. SIDE YARD - 50 FT. COMB. NOT LESS THAN 20 FT - 35 FT. PROV'D  
E. REAR YARD - 50 FT. REQ'D - 105 FT. PROV'D  
F. MAX HEIGHT - 35 FT. MAX REQ'D - 30 FT. PROV'D
- BUILDING SIZE -  
- PHASE 1 1450 GSF - 240 SEATS  
- FUTURE PHASES 4612 GSF - 410 SEATS
- REQUIRED PARKING-  
PHASE 1 -  
- 1 SPACE / 3 SEATS - 240 SEATS/3 = 80 SPACES  
- 90 SPACES PROVIDED  
FUTURE PHASES  
- 410 SEATS/3 = 151 REQ'D - 145 POSSIBLE
- SOILS ON SITE ARE GENERALLY SANDY CLAY TO SILTY CLAY.
- DETAILED LANDSCAPE PLANS WILL BE SUBMITTED FOR APPROVAL WITH BUILDING PERMIT APPLICATION
- PHOTOMETRIC PLAN WILL BE SUBMITTED FOR APPROVAL WITH BUILDING PERMIT APPLICATION

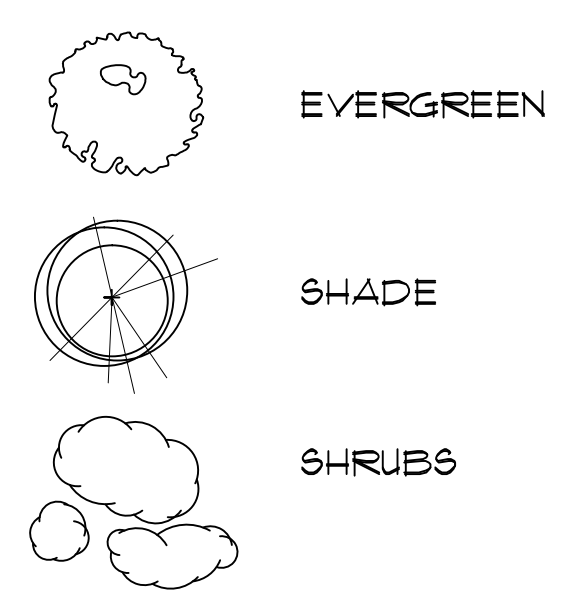

APPLICANT:  
SPIRIT OF LIFE LUTHERAN CHURCH  
9809 CHERRY VALLEY AVE SE  
CALEDONIA, MI 49316

PREPARER:  
DAN VOS CONSTRUCTION COMPANY  
JOSEPH L. GEEELHOED P.E.  
6160 E. FULLTON, PO BOX 189  
ADA, MI 49301

**SPIRIT OF LIFE  
LUTHERAN CHURCH**  
1638 BROADMOOR AVE. SE  
CALEDONIA, MICHIGAN

ARCHITECTURAL SERVICES  
DESIGN • BUILD  
CONSTRUCTION MANAGEMENT  
GENERAL CONTRACTING  
6160 E. FULLTON  
P.O. BOX 189  
ADA, MI 49301-0189  
(616) 676-9169

**DAN VOS  
CONSTRUCTION COMPANY**  
Building for Life.

ISSUED FOR:  
10-11-12: LAYOUT PLAN  
10-31-12: SPECIAL USE PERMIT

DRAWN: JLG  
PROJECT # 106602D

DRAWING NO: C-1